

# Brookstone

## Personal Mini Massager

PORTABLE SIZE, SOOTHING  
RELAXATION ANYWHERE



### IMPORTANT SAFETY INSTRUCTIONS

All of the safety and operating instructions should be read, adhered to and followed before the unit is operated.

### CAUTION

- To reduce the risk of electric shock, do not remove cover. There are no serviceable parts inside.
- To reduce the risk of fire or electric shock, do not expose this unit to rain or moisture.



The exclamation point within an equilateral triangle is intended to alert the user to the presence of important operating and maintenance (servicing) instructions in the literature accompanying the unit.



The lightning flash with arrow-head symbol within an equilateral triangle is intended to alert the user to the presence of uninsulated "dangerous voltage" within the unit's enclosure that may be of sufficient magnitude to constitute a risk of electric shock.

For adult use only. Remove all scarves, neckties, necklaces, and jewelry before using this massager. **IMPORTANT:** Any individual who may be pregnant, has a pacemaker, suffers from diabetes, phlebitis and/or thrombosis, is at an increased risk of developing blood clots, or who has pins/screws/artificial joints or other medical devices implanted in his/her body should consult with a physician before using a massaging device designed for home use.

### SAVE THESE INSTRUCTIONS

### WARNING

1. Do not subject product to excessive force, shock, dust, temperature or humidity.
2. Do not immerse product in water. If you spill liquid on it, dry it immediately with a soft, lint-free cloth.
3. Do not clean product with abrasive or corrosive materials.
4. Do not tamper with product's internal components. This invalidates the warranty.
5. Dispose of this product as you would an expired battery.

### CAUTION

- Consult your doctor before using this product.
- Never leave the product operating or unattended, especially if children are present.
- Never use the product on open skin eruptions or on swollen or inflamed areas.
- Do not operate after taking painkillers, sedatives or alcohol. Consult your doctor if under these medications.
- Do not operate for more than 15 minutes continuously.
- The product is designed to soothe tired and aching muscles. It is not intended to be a substitute for medical attention. If your ailments and symptoms persist or worsen after use, contact your doctor immediately.
- Intended for consumer use only.

### PARTS AND ACCESSORIES

1. USB/AC Adapter
2. Massager Node
3. Flexible Neck
4. Handle
5. Power/Speed Button
6. DC Jack
7. LED Charging Indicator
8. USB Charging Cable

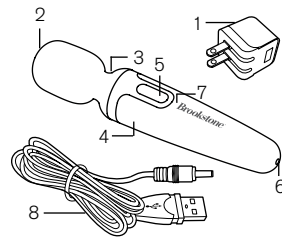



Since 1965, people have come to Brookstone to see what's new, discover smart solutions to everyday problems—and have some fun. At Brookstone, we believe there's always a better way to do things. And we created a world of innovation to prove it.

Merrimack, New Hampshire USA 03054  
800-846-3000 • Brookstone.com

792450

## CHARGING MASSAGER

Fully charge massager before first use.

1. Plug the USB Cable into massager's Adapter Jack.
2. Connect other end of cable to a 2.0 USB port or into the USB/AC adapter's USB port.
3. Plug the USB Jack into a 2.0 USB port, or plug the USB/AC Adapter into an electrical outlet to charge.
4. LED Charging Indicator will light up in red, then change to blue when fully charged.
5. LED Charging Indicator will flash red when re-charge is needed.
6. Approximate charging time is 2 hours.

## OPERATION OF MASSAGER

1. Press and hold the Power/Speed button to activate. It will start massage in Low. The massager has 3 levels.
  - Low—gentle vibration
  - High—strong vibration
  - Pulse vibration
2. Press the Power/Speed button to rotate from Low, High, Pulse and Off.

## SPECIFICATIONS

Dimensions: 5.9" x 1.1" x 1.1"

Weight: 2 oz.

Power: Built-in rechargeable lithium ion battery

Electric Current: 300 mA

Voltage: 3.7 V

Node Vibration: 6,000 rpm (approximately)

Battery Life: 1 hour at high speed (approximately)

Water (splash) Resistant

Auto Power Off after 20 minutes

## ONE (1) YEAR LIMITED WARRANTY

Brookstone® warrants this product against defects in materials and/or workmanship under normal use for a period of ONE (1) YEAR from the date of purchase by the original purchaser ("Warranty Period"). If a defect arises and a valid claim is received within the Warranty Period, at its option, Brookstone will either 1) repair the defect at no charge, using new or refurbished replacement parts, or 2) replace the product with a new product that is at least functionally equivalent to the original product, or 3) provide a store credit in the amount of the purchase price of the original product. A replacement product or part, including a user-installable part installed in accordance with instructions provided by Brookstone, assumes the remaining warranty of the original product. When a product or part is exchanged, any replacement item becomes your property and the replaced item becomes Brookstone's property. When a store credit is given, the original product must be returned to Brookstone and becomes Brookstone's property.

**Obtaining Service:** To obtain warranty service, call Brookstone Limited Warranty Service at 1-800-292-9819. Please be prepared to describe the product that needs service and the nature of the problem. A purchase receipt is required. All repairs and replacements must be authorized in advance. Service options, parts availability and response times will vary. You are responsible for delivery and the cost of delivery of the product or any parts to the authorized service center for replacement, per our instructions.

**Limits and Exclusions:** Coverage under this Limited Warranty is limited to the United States of America, including the District of Columbia and the U.S. Territories of Guam, Puerto Rico, and the U.S. Virgin Islands. This Limited Warranty applies only to products manufactured for Brookstone that can be identified by the "Brookstone" trademark, trade name, or logo affixed to them or their packaging. The Limited Warranty does not apply to any non-Brookstone products. Manufacturers or suppliers

other than Brookstone may provide their own warranties to the purchaser, but Brookstone, in so far as permitted by law, provides these products "as is." This warranty does not apply to: a) damage caused by failure to follow instructions relating to product's use or the installation of components; b) damage caused by accident, abuse, misuse, fire, floods, earthquake or other external causes; c) damage caused by service performed by anyone who is not a representative of Brookstone; d) accessories used in conjunction with a covered product; e) a product or part that has been modified to alter functionality or capability; f) items intended to be periodically replaced by the purchaser during the normal life of the product including, without limitation, batteries or light bulbs; g) any product sold "as is" including, without limitation, floor demonstration models and refurbished items; or h) a product that is used commercially or for a commercial purpose.

**BROOKSTONE SHALL NOT BE LIABLE FOR INCIDENTAL OR CONSEQUENTIAL DAMAGES RESULTING FROM THE USE OF THIS PRODUCT, OR ARISING OUT OF ANY BREACH OF THIS WARRANTY. TO THE EXTENT PERMITTED BY APPLICABLE LAW, BROOKSTONE DISCLAIMS ANY AND ALL STATUTORY OR IMPLIED WARRANTIES, INCLUDING, WITHOUT LIMITATION, WARRANTIES OF MERCHANTABILITY, FITNESS FOR A PARTICULAR PURPOSE AND WARRANTIES AGAINST HIDDEN OR LATENT DEFECTS. IF BROOKSTONE CANNOT LAWFULLY DISCLAIM STATUTORY OR IMPLIED WARRANTIES, THEN TO THE EXTENT PERMITTED BY LAW, ALL SUCH WARRANTIES SHALL BE LIMITED IN DURATION TO THE DURATION OF THIS EXPRESS WARRANTY.**

Some states disallow the exclusion or limitation of incidental or consequential damages or how long an implied warranty lasts, so the above exclusions or limitations may not apply to you. This warranty gives you specific legal rights and you may also have other rights, which vary from state to state.